



## Description

Delta Water Based Epoxy Resin is suitable for all applications where concrete, or masonry requires waterproofing and protection. It is applied in the same manner as ordinary emulsion paint with the added benefit of application in damp conditions. Once dried Water Based Epoxy leaves a tough, non-toxic, waterproof, damp proof and easy to clean surface.

Supplied in a twin-pack. Mixing Delta Water Based Epoxy couldn't be easier – simply remove the ring which holds both tins together. Add Pack B (smaller tin) into Pack A (larger tin) stirring continuously. Stirring should be for a minimum 5 minutes from time when Part A and Part B are added together.

## Features

- As a membrane to prevent rising damp in floors or anti-lime treatment of new concrete
- As a general waterproofing and decorative finish for all brick, concrete, cement and masonry surfaces
- For damp surfaces where other paints cannot adhere
- As a tank lining for protection against mild chemicals
- All other applications where a waterproofing coating is required
- Non-Toxic, tough, and durable

## Specification

- NBS Specification J30 Liquid Applied damp proofing/Tanking 110 – Cold Applied

## Product Details

| Delta Water Based Epoxy Resin |         |       |
|-------------------------------|---------|-------|
| DMS 485                       | 2.5 ltr | White |
| DMS 486                       | 2.5 ltr | Clear |
| DMS 487                       | 2.5 ltr | Grey  |
| DMS 488                       | 2.5 ltr | Blue  |
| DMS 144                       | 5 ltr   | White |
| DMS 148                       | 5 ltr   | Clear |
| DMS 149                       | 5 ltr   | Grey  |
| DMS 150                       | 5 ltr   | Blue  |

## Technical Data

| Delta Water Based Epoxy Resin |   |
|-------------------------------|---|
| DMS                           | 485-140   |
| Curing                        | Tough cure in 4 hours.<br>Hard dry in 12 hours.<br>Maximum cure in 8 days   |
| Packaging                     | Two-Part product  |
| Coverage                      | Coverage is approximately 7 m <sup>2</sup> per 1 litre. This may be reduced on rougher more porous substrates   |
| Storage                       | Store in a cool, dry conditions. Store in original tinned packaging. Protect from frost.  |
| Shelf life                    | A shelf life in excess of 12 months can be expected   |
| Cleaning equipment            | If using spray equipment, rinse thoroughly with cold water frequently to avoid build up of cured paint. Brushes and rollers should be washed in cold water and mild detergent |



NBS Source

**Locations of use**

- Basements and areas needing a damp proof membrane
- Water tanks and sewage treatment plants
- Abattoirs and fisheries
- Dairies, milking parlours, food factories, breweries
- Grain silos, bunds and water plants
- Chemical industry garages
- Plant rooms

**Application**

- Simply mix pack B into Pack A, stirring continuously and add water to fill line.
- As easy to use as ordinary emulsion paint, apply using a brush, roller or spray.
- 2nd coat should be applied as soon as 1st coat is touch dry.

**Technical Drawing - DW-225-1-(F)**

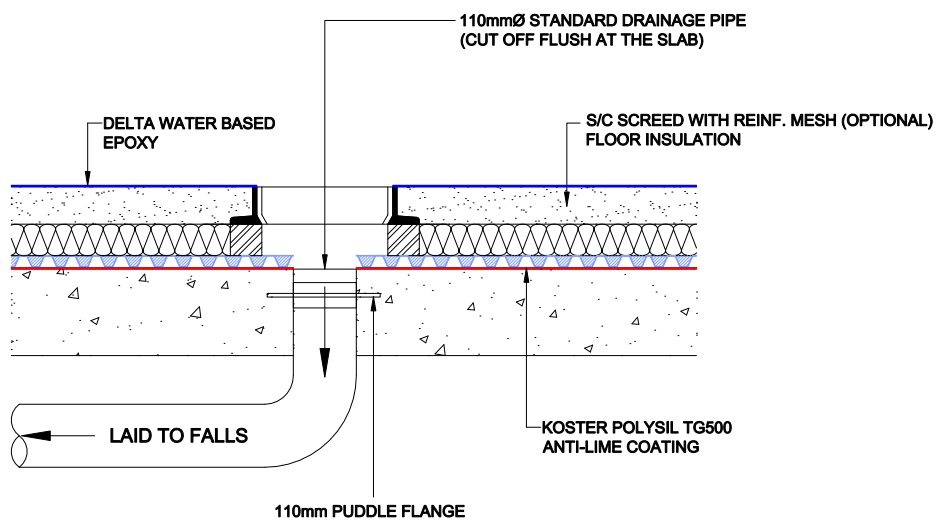

**FLOOR DRAIN DETAIL ALLOWING ACCESS TO MEMBRANE AND DRAINAGE SYSTEM**

- TYPICAL USE IN PLANT ROOMS
- GROUND FLOOR FLOOD RESILIENCE

**Other Information**

All data and information contained in these Product/Technical Data Sheets is up-to-date and correct as at the date of issue. The information given is suggested as guidance and should only be used for evaluating your specific application. Delta Membrane Systems Limited cannot control or anticipate the conditions under which this product may be used, each user should review the information in specific context of the planned use. The information contained in these Product/Technical Data Sheets should not be considered a warranty, expressed, or implied, including but not limited to a warranty of merchantability or fitness for a particular purpose. In no event shall Delta Membrane Systems Limited be liable for any incidental or consequential damages resulting from the use, misuse, or inability to use the product. This exclusion applies regardless of whether such damages are sought based on breach of warranty, breach of contract, negligence, strict liability in tort, or any other legal theory. When in doubt, contact Delta's Technical Team on 01992 523 523.